

A1 Overview

Front/Back

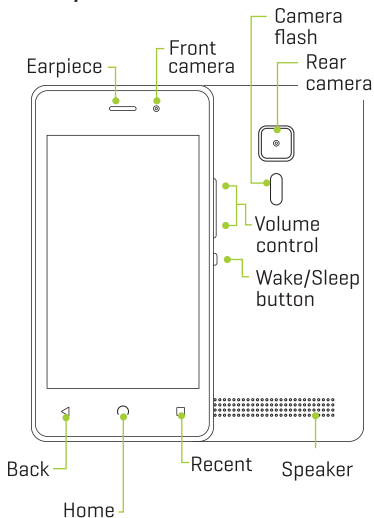

Top

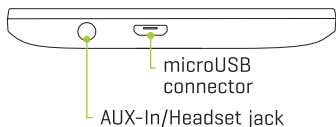

Setting Up Your Phone

Follow these step-by-step instructions to set up your A1.

Power off the phone and remove battery **before** inserting any cards!

1 Remove Back Cover

- Remove the back cover by prying the lower left corner of your device with your fingers.

2 Insert SIM

- Orient SIM card to match diagram on slot.
- SIM 1 (Standard) and SIM 2 (Micro) both support 4G connections. However, they could not be 4G at the same time.

3 Insert microSD™ Memory Card (Optional)

- Power off the phone and remove battery before inserting memory card.

4 Insert the Battery

- Align the battery contacts, then insert the battery contact-first.

5 Replace Back Cover

- After installing the SIM card, memory card, and battery, align the cover and snap it closed. Make sure you press all around the edge to ensure a secure fit.

6 Charge/Sync

- Plug in the microUSB connector to charge the phone or transfer data.

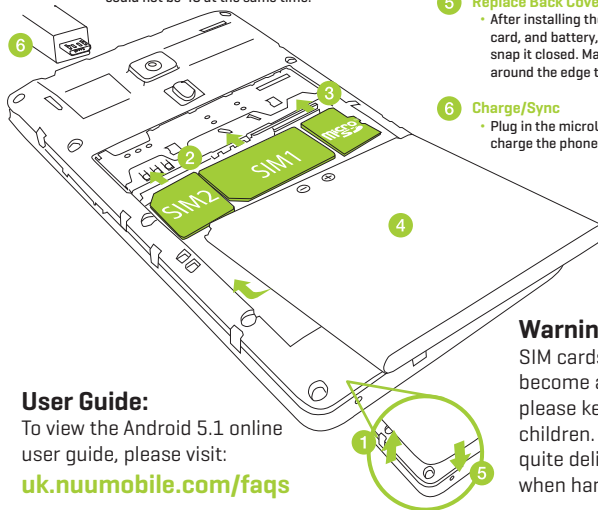

Warning:

SIM cards are small enough to become a choking hazard, so please keep them away from children. SIM cards are also quite delicate. Please be careful when handling your card.

User Guide:

To view the Android 5.1 online user guide, please visit:

uk.numobile.com/faqs

Need help?



Any problems, just call: **0333 121 0239***

Or email us at: **support@uk.nuumobile.com**

Our office hours are:

Mon - Fri	08:00 to 19:00 GMT/BST
Sat:	08:00 to 19:00 GMT/BST
Sun:	10:00 to 16:00 GMT/BST

Or visit our FAQ page: **uk.nuumobile.com/faqs**

*For calls outside of the UK +44 333 121 0239, standard international call charges apply.